

# ROCKWOOL™ Rainscreen™

## Non-combustible insulation for Ventilated facades

ROCKWOOL™ Rainscreen™ is a stone wool insulation developed specifically for use within ventilated cladding systems.

ROCKWOOL™ Rainscreen™ is non-combustible, it does not develop toxic smoke nor promote flame spread, even when directly exposed to fire. It also contributes to a building's energy efficiency with its reliable thermal performance. It is moisture repellent, allowing the structure to maintain breathability and dryness. The superior performances of ROCKWOOL™ Rainscreen™ ensure that its insulation value can be maintained for a long time.

Compatible with numerous cladding attachment systems, the product can be easily fitted around brackets and other awkward details. When tightly butted, adjacent slabs effectively 'knit' together to provide a continuous insulating layer, reducing heat loss that would otherwise be caused by gaps.

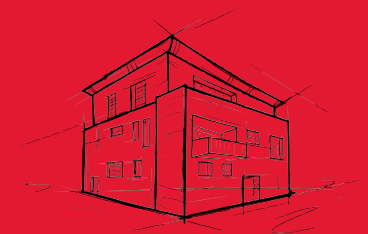

### Fire Performance

The non-combustible characteristics of ROCKWOOL Rainscreen insulation means that it will not develop toxic smoke or promote flame spread even when directly exposed to fire.

# ROCKWOOL™ Rainscreen™

**Technical Data Sheet**  
Ventilated Facade Insulation  
27 January 2026

## Technical Parameters

Product Name	ROCKWOOL™ Rainscreen SL950	ROCKWOOL™ Rainscreen SL960	Test Standard
Density	80 kg/m <sup>3</sup>	100 kg/m <sup>3</sup>	N/A
Reaction to Fire	Non-combustible Euroclass A1	Non-combustible Euroclass A1	AS 1530.1 EN 13501-1
Fire Hazard Properties	Ignitability: 0 Spread of flame: 0 Heat evolved: 0 Smoke developed: 0-1	Ignitability: 0 Spread of flame: 0 Heat evolved: 0 Smoke developed: 0-1	AS 1530.3
Melting Point	1000°C	1000°C	ASTM E794
Thermal Conductivity at mean 23°C	0.035 W/mK	0.034 W/mK	ASTM C518
Water Absorption (partial immersion)	0.5 kg/m <sup>2</sup>	0.5 kg/m <sup>2</sup>	BS EN ISO 29767
Water Vapor Absorption	Less than 0.04 Vol %	Less than 0.04 Vol %	ASTM C1104/ 1104M
Water Repellent	99 %	99 %	GB/T 10299

## Application

ROCKWOOL™ Rainscreen™ is suitable for use on the following construction types:

- Steel frame, timber frame or masonry walls in conjunction with a cladding system
- Steel frame or timber frame with a masonry outer leaf

## Compliance with the Australia NCC

The above range of ROCKWOOL™ products, when properly specified and installed, demonstrates the following compliance:

- **Thermal**  
Complies with AS/NZS 4859.1 and meets the requirements of NCC through adherence to NCC 2022 Volume 1 Section J4D3 (1), NCC 2019 Volume 1 Section J1.2(a), NCC 2019 Volume 2 Section 3.12.1.1(a) and state-prescribed variations.
- **Fire Hazard Properties**  
Adheres to NCC 2019 Volume 1 Specification C1.10 Clause 7 and NCC 2022 Specification 7 Clause S7C7 for insulation materials. When tested to AS1530.3, these products conform to the "Spread of Flame" and "Smoke Developed" requirements outlined in NCC 2022 Specification 7 Clause S7C7 and NCC 2019 Volume 1 Specification C1.10 Clause 7.
- **Non-Combustibility**  
Complies with the non-combustibility standards of NCC 2022 Volume 1 C2D2 and NCC 2019 Volume 1 C1.9(a) or satisfies the testing criteria outlined in AS 1530.1.

## Facings

ROCKWOOL™ Rainscreen™ series is available as plain products and additionally with options of foil facing or glass tissue on one side or two-sided.

## Packaging and Storage

ROCKWOOL™ Rainscreen™ is shrink-wrapped in polyethylene sheets for ease of handling, transportation and storage. Products should be stored in doors or under waterproof covering.

## Health & Safety

ROCKWOOL™ stone wool products are manufactured from FBS-1 stone wool. FBS-1 stone wool is safe to use and the fibre component of these products is listed by Safe Work Australia as Man-made Vitreous Fibre (stone wool) of low bio persistence as specified under Note Q in the Australian Hazardous Substances Information System and in the Australian Approved Criteria.

For more information at [www.rockwool.com/anz](http://www.rockwool.com/anz)

# ROCKWOOL™ Rainscreen™

**Technical Data Sheet**  
Ventilated Facade Insulation  
27 January 2026

## Water resistance

ROCKWOOL™ stone wool insulation repels liquid water due to its fibre orientation and the presence of water-repellent additives.

## Condensation control

The vapour resistivity of ROCKWOOL™ stone wool is 5.9MN/gm. The slabs therefore reduce the risk of condensation, allowing natural drying-out of the structure. See typical relative humidity / temperature graph below.

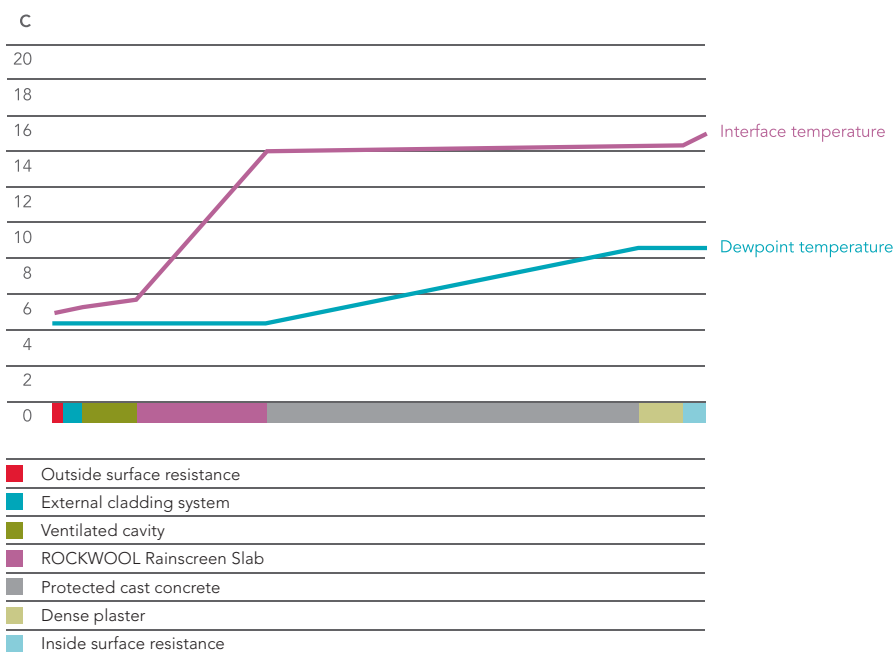

## Product specification

### ROCKWOOL™ Rainscreen™ SL950

R-Value m²K/W	Thickness (mm)	Width (mm)	Length (mm)	# Pieces per pack	Area per pack (m²)
0.70	25	600	1200	12	8.64
0.85	30	600	1200	10	7.20
1.10	38	600	1200	8	4.32
1.45	50	600	1200	6	4.32
2.15	75	600	1200	4	2.88
2.55	90	600	1200	3	2.16
2.85	100	600	1200	3	2.16
3.55	125	600	1200	2	1.44

### ROCKWOOL™ Rainscreen™ SL960

R-Value m²K/W	Thickness (mm)	Width (mm)	Length (mm)	# Pieces per pack	Area per pack (m²)
0.75	25	600	1200	12	8.64
0.90	30	600	1200	10	7.20
1.10	38	600	1200	8	4.32
1.45	50	600	1200	6	4.32
2.20	75	600	1200	4	2.88
2.65	90	600	1200	3	2.16
2.95	100	600	1200	3	2.16
3.70	125	600	1200	2	1.44



Disclaimer: The information contained in this data sheet is only applicable for Australia and is believed to be correct at the date of publication and is subject to change after the date of printing. This data sheet was designed for general information purpose only. It's contents should not be construed as representing all performance for these insulation materials. You should not act or rely on any of the information contained herein without seeking professional advice. We make no representations as to accuracy, completeness, correctness, suitability or validity of any information in this document and will not be liable for any errors, omissions, or delays in this information or any losses, injuries or damages arising from its use. All information is provided on a as-is basis.

**ROCKWOOL Australia Pty Ltd**  
Level 12, 90 Arthur Street,  
North Sydney, NSW 2060, Australia.  
info.au@rockwool.com

**ROCKWOOL Malaysia Sdn Bhd**  
Lot 4, Solok Waja 1, Bukit Raja Industrial  
Park, 41050 Klang, Selangor, Malaysia.  
T (+60) 3 3346 8200  
info.my@rockwool.com

For more information at [www.rockwool.com/anz](http://www.rockwool.com/anz)